

**SPEIRS  
MAJOR**

King's Cross Lighting Masterplan,  
London, UK

**LIGHT  
ARCHITECTURE**

8 Shepherdess Walk  
London,  
N1 7LB  
United Kingdom

T +44 (0)20 7067 4700

Co-lab Shibuya Cast  
23-21, Shibuya 1-Chome  
Tokyo 150-0002  
Japan

T +81 (0)3 3400 8855

[info@smlightarchitecture.com](mailto:info@smlightarchitecture.com)  
[press@smlightarchitecture.com](mailto:press@smlightarchitecture.com)

# SPEIRS MAJOR

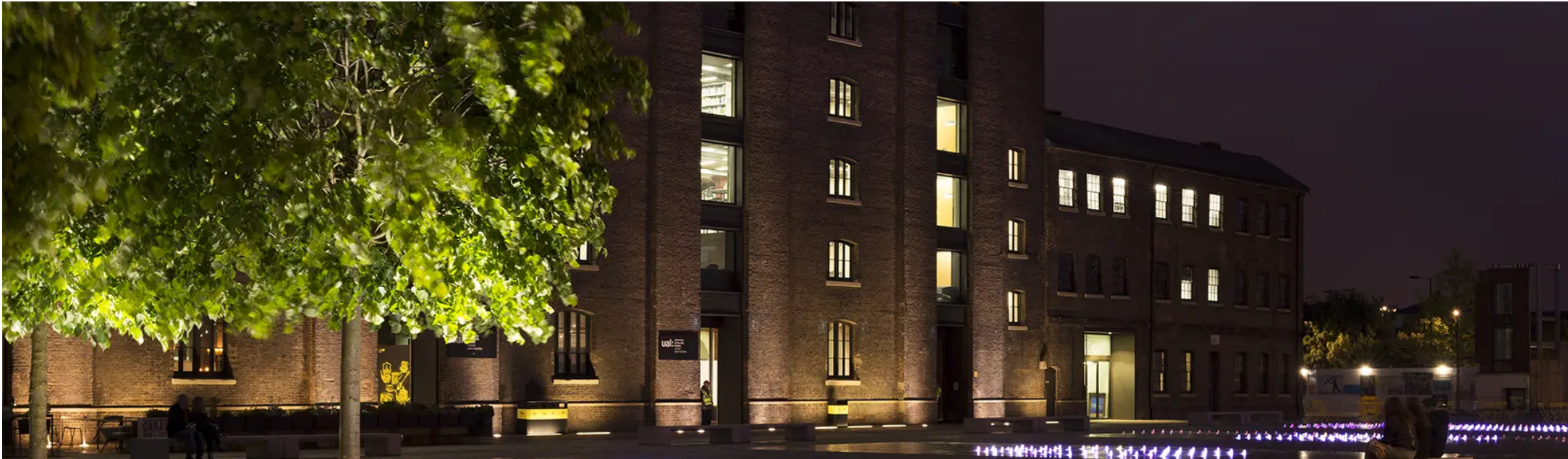

The Lighting Masterplan carefully knits the unique King's Cross site into its local context after dark.

CLIENT  
Argent

ARCHITECT  
Allies and Morrison

LANDSCAPE ARCHITECT  
Townshend  
Landscape Architects

PROJECT TEAM  
Mark Major

# SPEIRS MAJOR

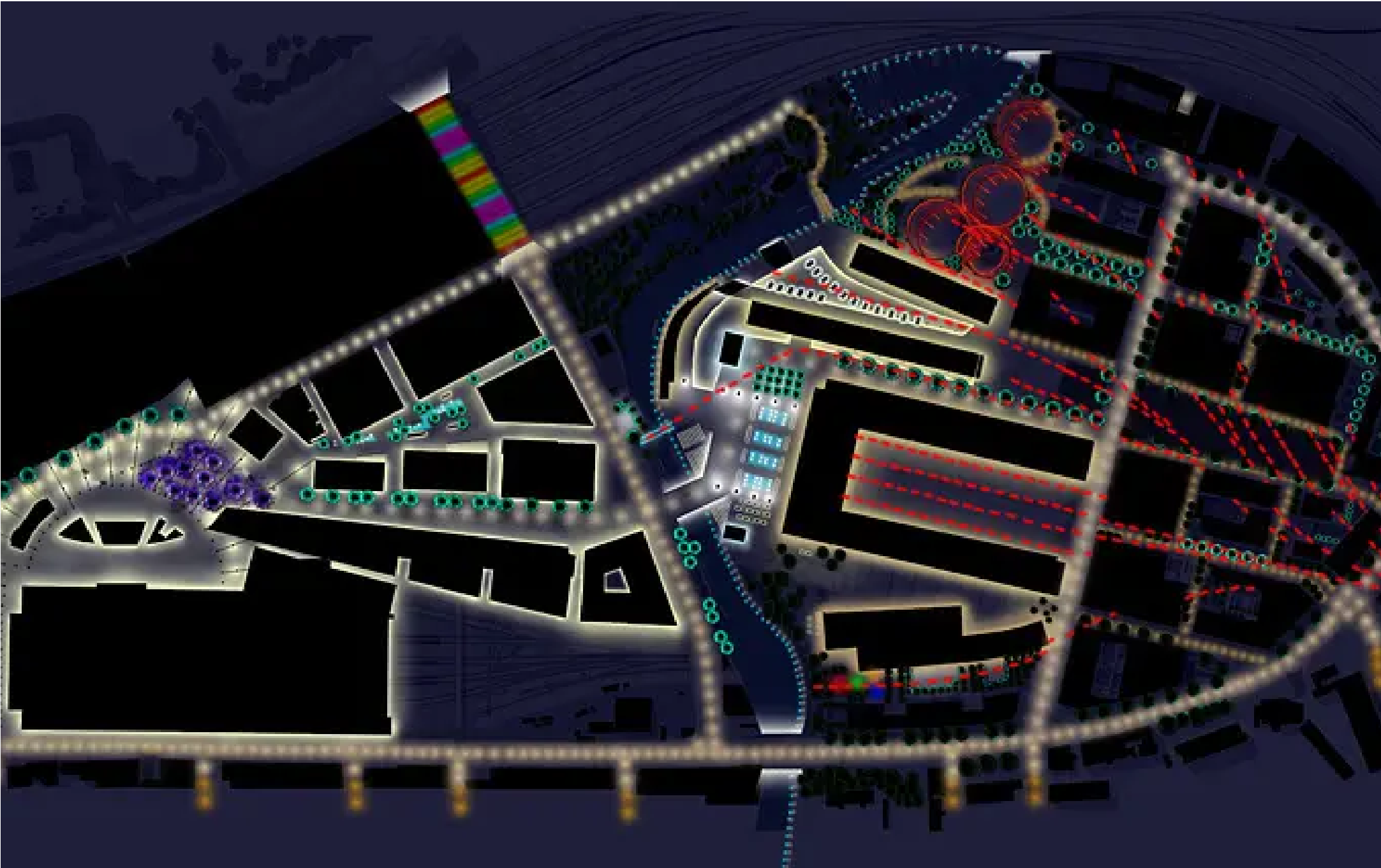

# SPEIRS MAJOR

King's Cross Central is one of the largest mixed used developments in the capital. Sited on the former goods yard north of King's Cross Station the project incorporates a rich mix of commercial, cultural and residential buildings. Speirs Major were initially commissioned by property developers Argent to develop a 'Lighting Masterplan' which would carefully knit the site into its local context after dark.

Particular focus was given to the illumination of the surviving industrial heritage, including the Grade II listed Granary by Lewis Cubitt, which was being converted into a new University of the Arts. The lighting of the towpath to the Regent's Canal, which traverses the site, also had to be carefully considered. Here the designers had to balance the safety requirements for pedestrians, cyclists and boat users with the need to limit the potential impact on local biodiversity.

Following the vision, the team were asked to work up a detailed lighting strategy for several areas including Granary Square, Wharf Road, the new University of the Arts, the redevelopment of the Western Transit Shed and a restaurant pavilion building, all by Stanton Williams Architects.

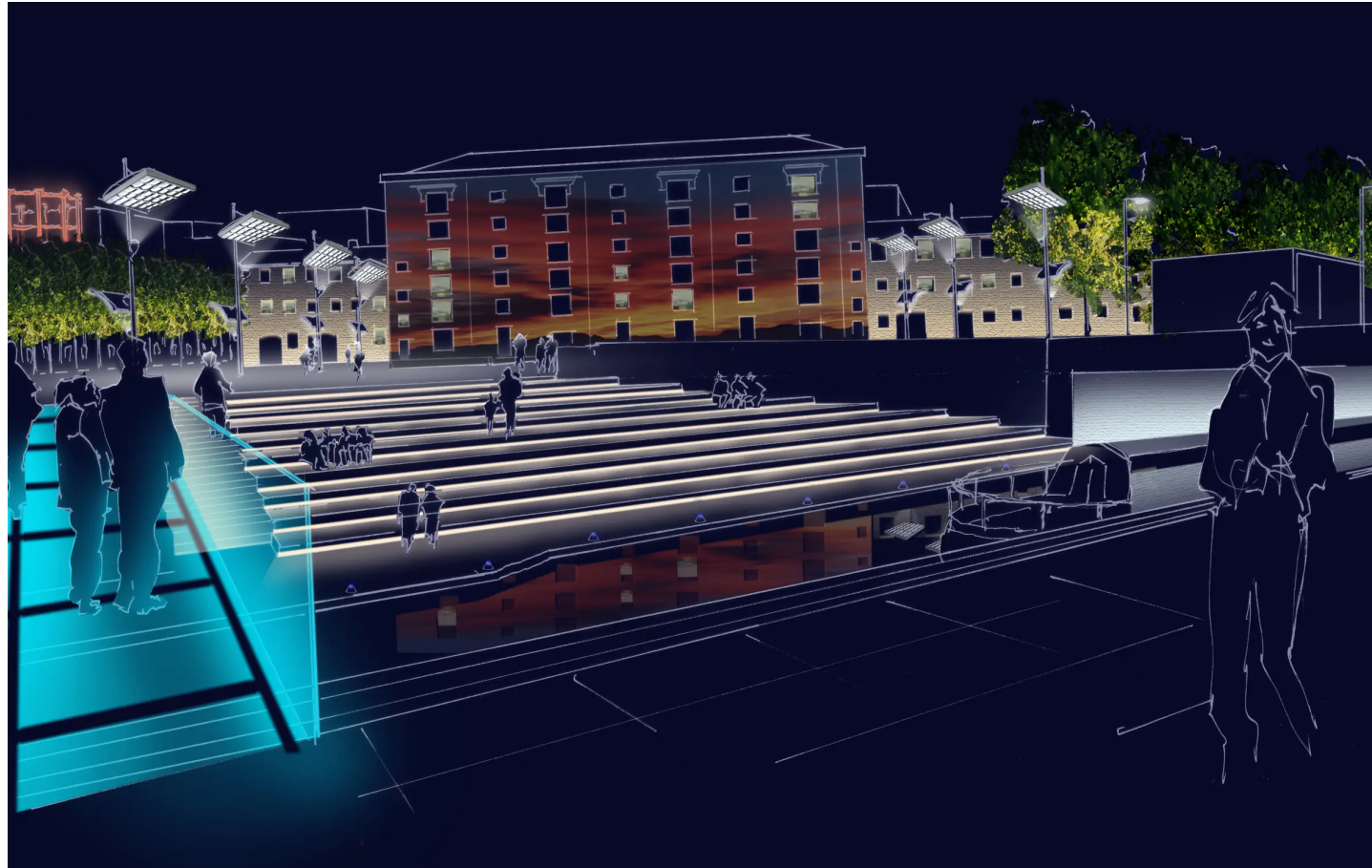

# SPEIRS MAJOR

